



Model Name	UFO-AC2800S100DL
Output Mode	Constant Current
Input Voltage	120-277 Vac
Input Frequency	50/60 Hz
Dimming	3 in 1 (PWM,1-10V,Resistance) 10-100% Dimming
Surge Rating	2KV
Warranty	5 Years $TC \leq 75^{\circ}C$ 3 Years $75^{\circ}C \leq TC \leq 90^{\circ}C$

Product Specification



Output Power (W)	Output Voltage (V)	Output Current (A)	Start Temp. ($^{\circ}F/^{\circ}C$)	Tcase Temp. ($^{\circ}F/^{\circ}C$)	Input Current (A)	Input Power (W)	Inrush Current (A)	THD (%)	Power Factor	Efficiency (%)
Max. 100	21-36	2.8	Min -40/-40	Max. 194/90	0.96@120V 0.42@277V	116	Max. 40	Max. 20	Min. 0.9	Typ. 87

Wire Diagram

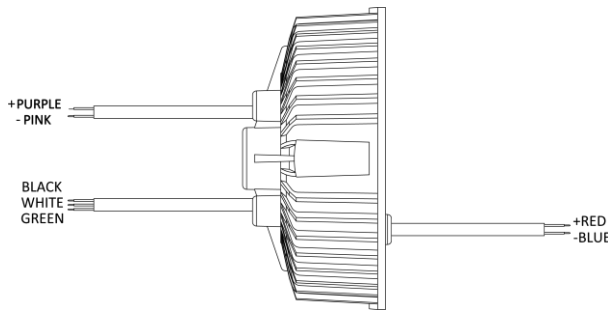

Maximum Wiring Distance (at full load) is 18AWG/18Feet

LED case should be grounded

Lead Length	Inch	Cm
Black	11.8	30
White	11.8	30
Green	11.8	30
Red	7.87	20
Blue	7.87	20
Purple	7.1	18
Pink	7.1	18

Enclosure

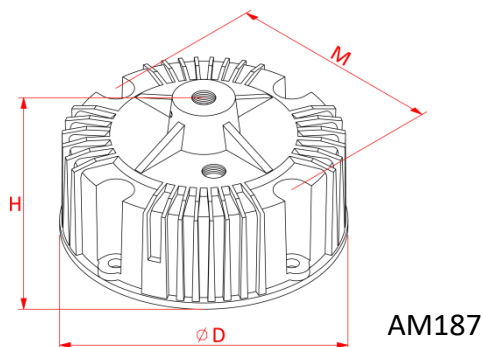

Enclosure	Inch	Cm
Length(L)	5.2	13.2
Width(W)	NA	NA
Height(H)	2.83	7.2
Mounting(M)	4.45	11.3



Input Specifications

Parameter	Min.	Typ.	Max.	Notes
Input Voltage	108V	120/277V	305V	
Input Current	-	-	0.5A RMS	@120Vac input with full load
Input Frequency	47Hz	60Hz	63Hz	
Leakage Current	-	-	0.7mA	@120Vac input
Turn On Time	-	-	1.0s	@120Vac input at full load
Hold Up Time	-	-	0.1s	@Nominal input and full load
Efficiency	87%	89%	91%	@277Vac input at full load
Standby Power	-	-	3W	
Current Total Harmonic	-	-	20%	

Output Specifications

Parameter	Min.	Typ.	Max.	Notes
Output Voltage	21V	-	36V	
Output Current	-	2800mA	-	
No-Load Output Voltage	54V	35V	36V	
Rated Current	2660mA	2800mA	2940mA	
Rated Power	-	100W	-	
Line Regulation	-	-	±5%	
Output Current Ripple	-	±10%	-	

General Specifications

Parameter	Min.	Typ.	Max.	Notes
MTBF	-	100,000 Hours	-	@25°C ambient temperature
Lifespan Time	75,000 Hours	-	-	In the range of specification required by normal use of the power supply at ambient temperature 55°C
Cold Start	-	-	1.0s	@-40°C



Protection

Parameter	Description
Over Voltage	Output current decade mode, recovers automatically after fault condition is removed.
Short Circuit	Hiccup mode, recovers automatically after fault condition is removed.
Over Temperature	Shut down o/p voltage, re-power on to recover.

Environmental Specifications

Parameter	Min.	Typ.	Max.	Notes
Operation Temperature	-40℃	-	80℃	
Storage Temperature	-40℃	-	80℃	
Humidity	10%	-	90%	
T-Case Temperature	-	-	90℃	

High Temperature Durability	Switch ON/OFF Test
Power storage environment at 80℃ 24hours, will not damage the electrical, mechanical properties and also not cause other adverse reactions.	Power at ambient temperature 25℃ 1s/on, 1s/off, last up to 10,000 cycles, will not damage the electrical mechanical properties and also not cause other adverse reactions.

Safety and EMC Compliance

Safety Standards	Withstand Voltage	Isolation Resistance	EMC Standards	
			EMI	EMS
UL 8750 UL1310	I/P-O/P: 2.0K Vac I/P-FG: 2.0K Vac O/P-FG: 0.5K Vac	I/P-O/P: I/P-FG: O/P-FG: 100Mohm/500VDC	FCC Part 15 class A UL8750 CSA C22.2 No. 250.13-14	FCC Part 15 class A UL 8750



Efficiency V.S. Load

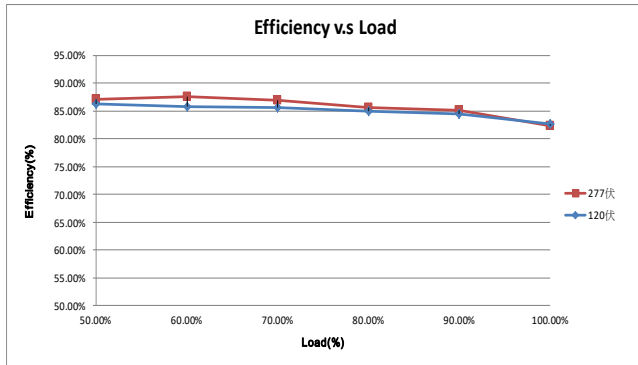

Derating Curve

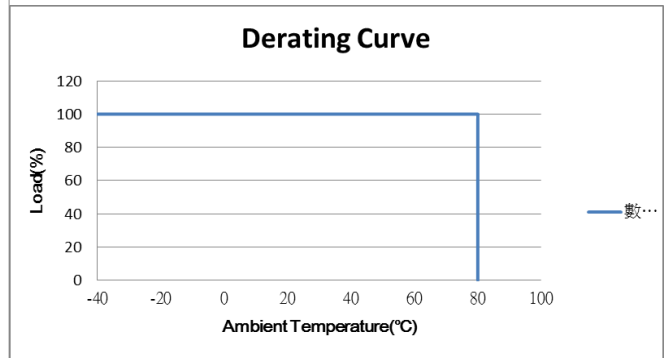

Life Time Curve

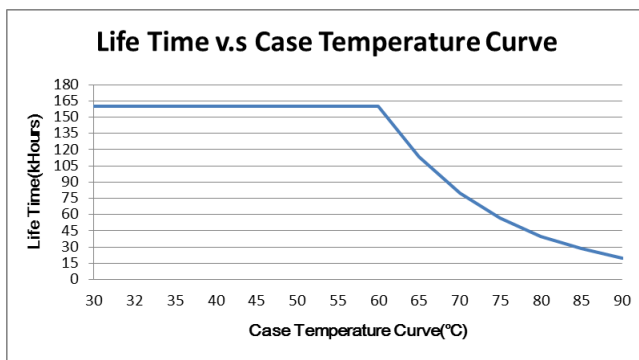

Power Factor V.S. Load

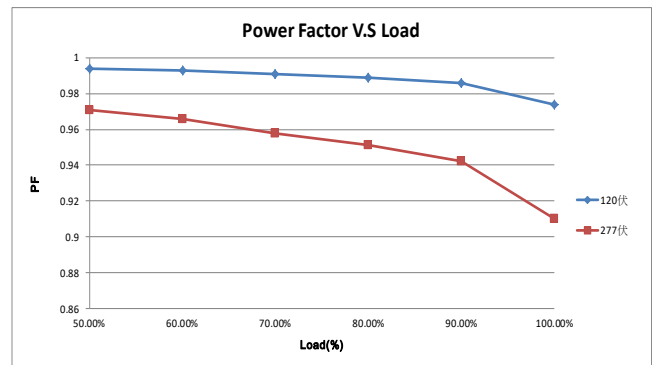

Dimming Characteristic

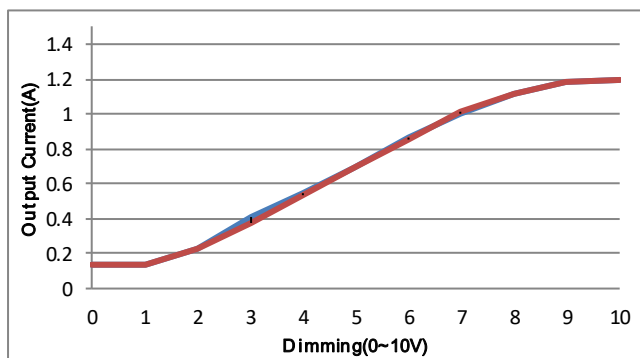

Data is based upon tests performed by Antron Electronics in a controlled environment and representative performance. Actual performance can vary depending on operating conditions. Specifications are subject to change without notice. All specifications are nominal unless otherwise noted