



<b>Model Name</b>	ALCR-G3
<b>Input Voltage</b>	120-277 Vac
<b>Input Frequency</b>	50/60 Hz
<b>Dimming</b>	0-10V
<b>Surge Rating</b>	3KV
<b>Relay Contact Ratings(SPST)</b>	3A @120Vac 3A @277Vac
<b>Warranty</b>	5 Years TC $\leq 60^{\circ}\text{C}$ 3 Years TC $\leq 66^{\circ}\text{C}$

## Product Specification



Relay Contact Ratings (SPST) (A) @120V	Relay Contact Ratings (SPST) (A) @277V	Emergency Power Supply Usage (mA)	Dimmer Contact Switching @250V (mA)	Input Power (W)	Input Current (mA)	Operation Temperature ( $^{\circ}\text{C}$ )
3	3	120	130	Max. 3	Max. 60	-20-65

## Wire Diagram

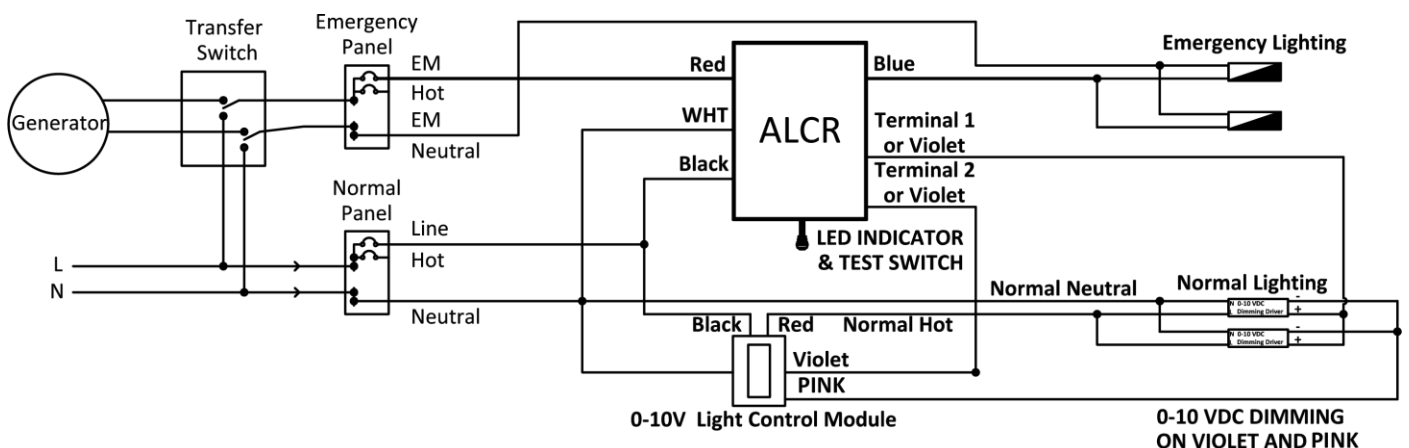

(A) With 0-10V Dimmer

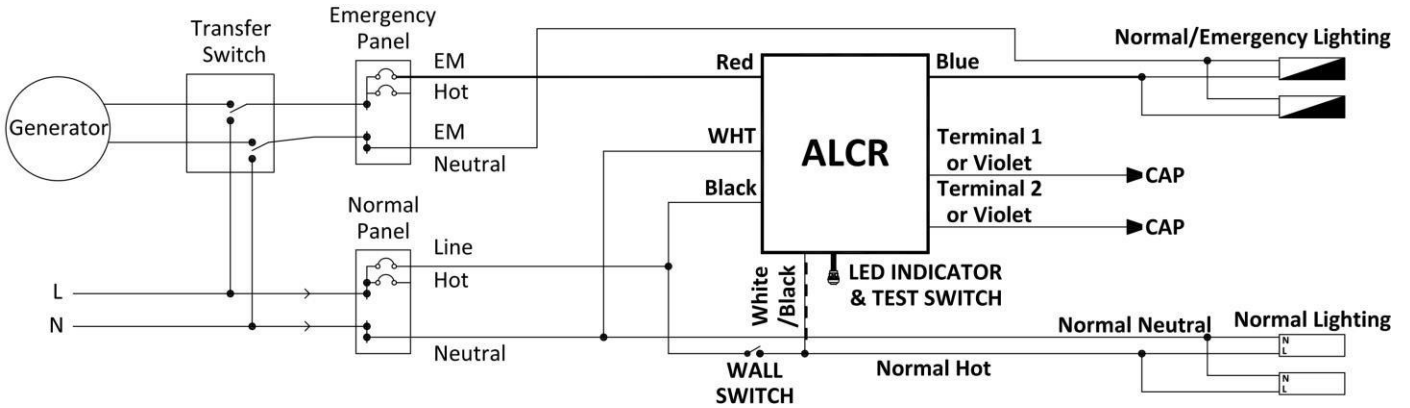

(B) Without Dimmer

Maximum Wiring Distance (at full load) is 18AWG/18Feet

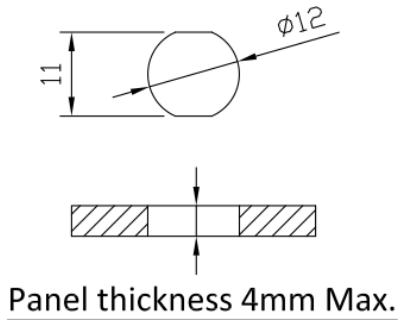

Panel thickness 4mm Max.

Test Switch

Lead Length	Inch	Cm
Black	6	15.2
White	6	15.2
Red	6	15.2
Blue	6	15.2
Violet(Terminal1)	7.08	18
Violet(Terminal2)	7.08	18
Test Switch LED INDICATOR	24/6	61/15.24

## Enclosure

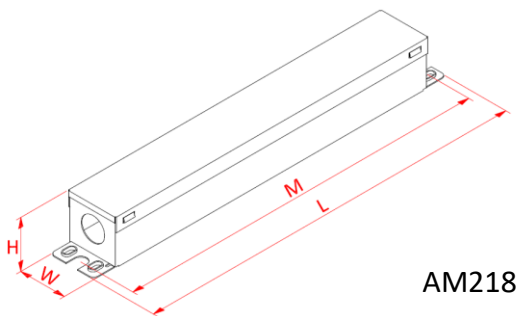

AM218

Enclosure	Inch	Cm
Length(L)	8	20.3
Width(W)	1.18	3.0
Height(H)	1.15	2.92
Mounting(M)	7.6	19.3